

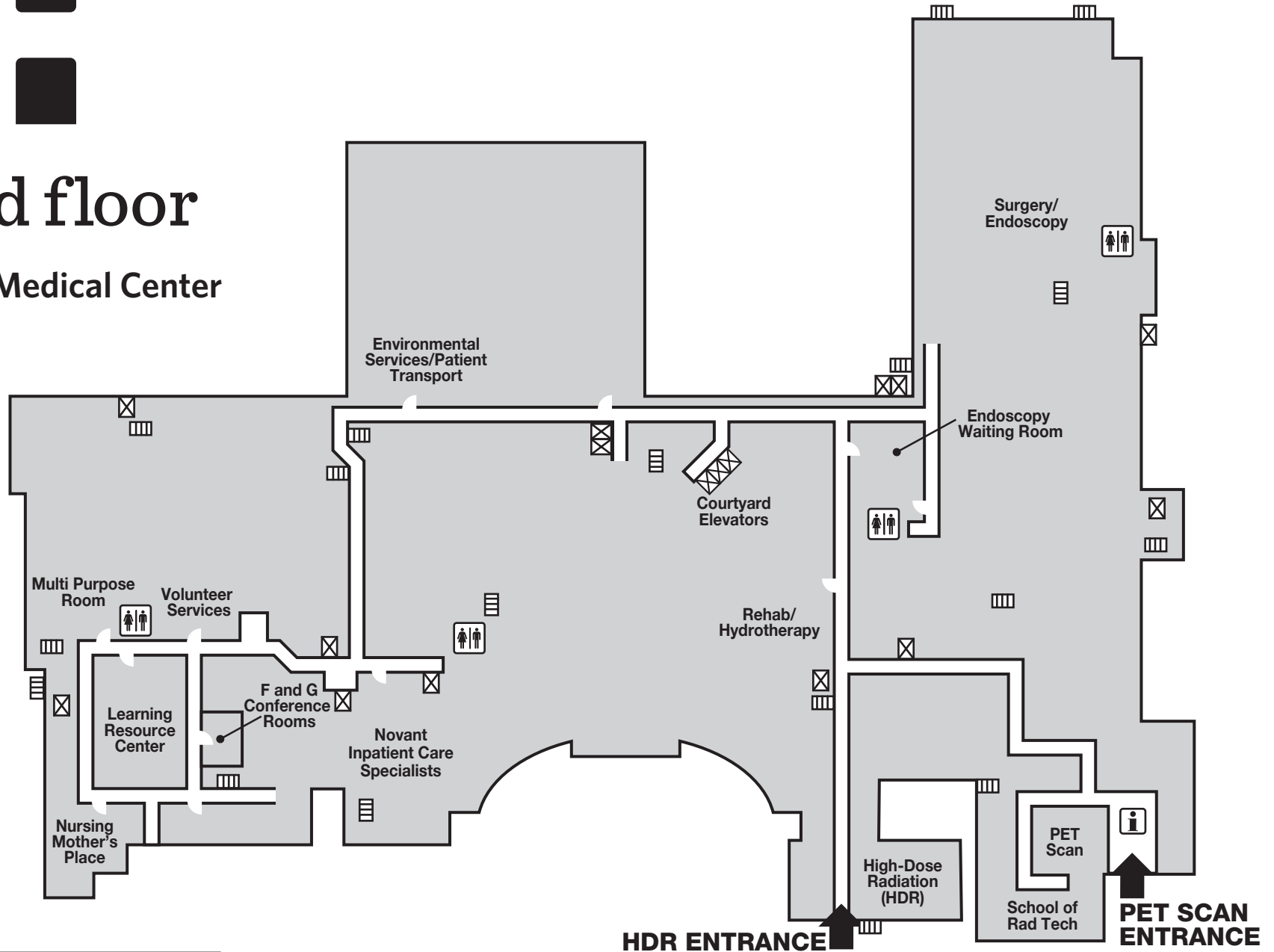

Ground floor

Presbyterian Medical Center

NovantHealth.org



Legend			



First floor

Presbyterian Medical Center

NovantHealth.org

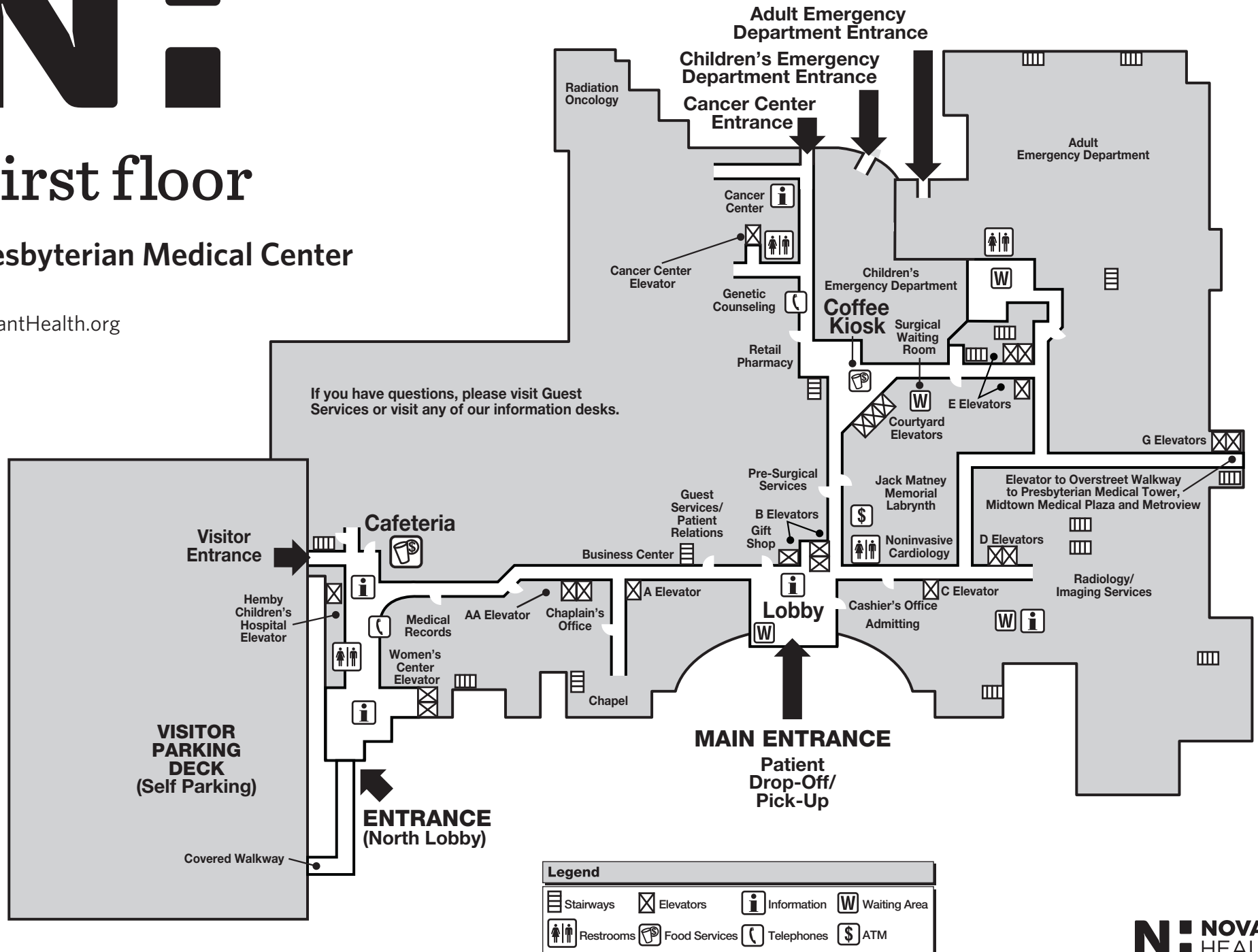



Second floor

Presbyterian Medical Center

NovantHealth.org

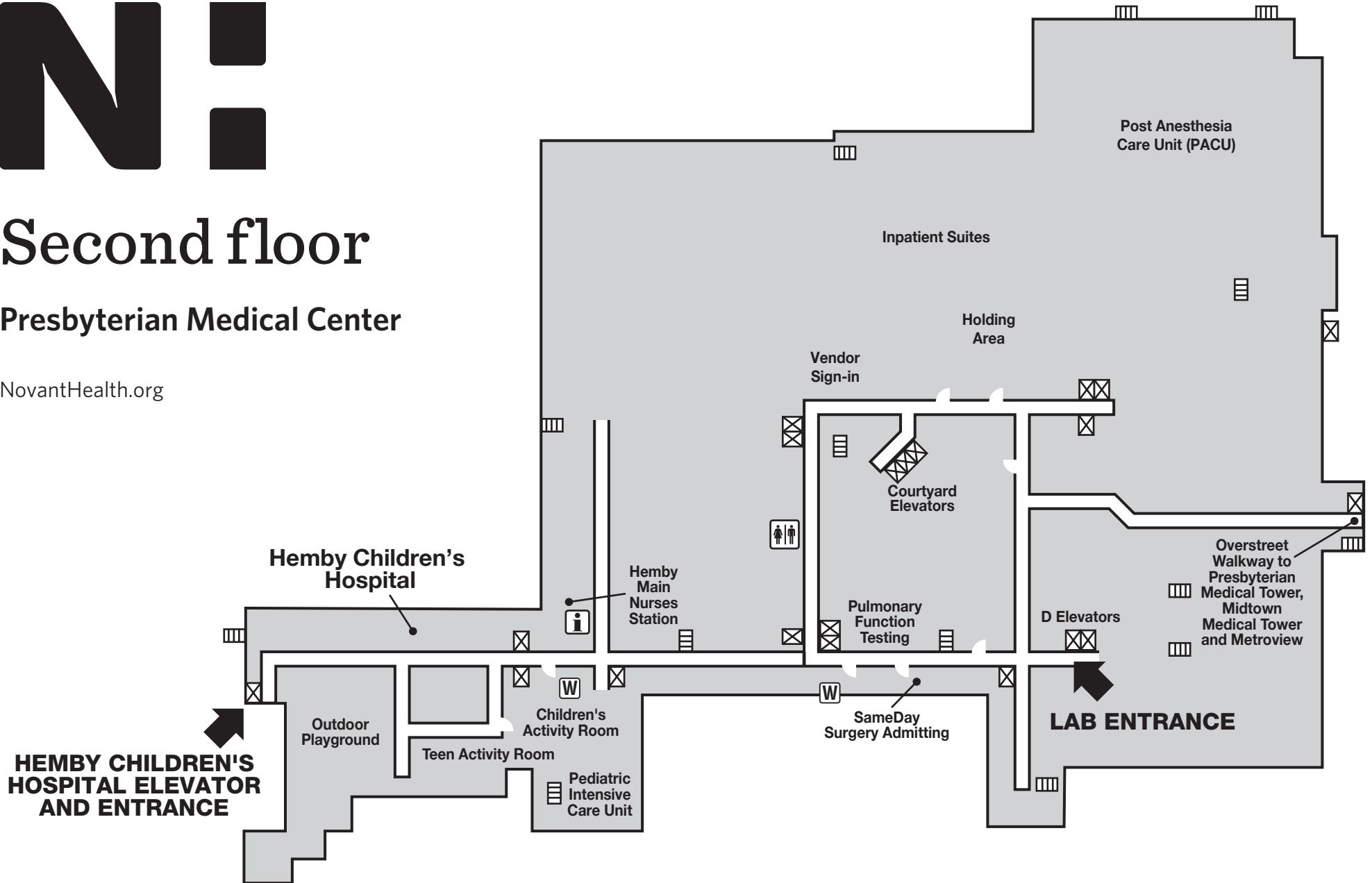

Legend			



Third floor

Presbyterian Medical Center

NovantHealth.org

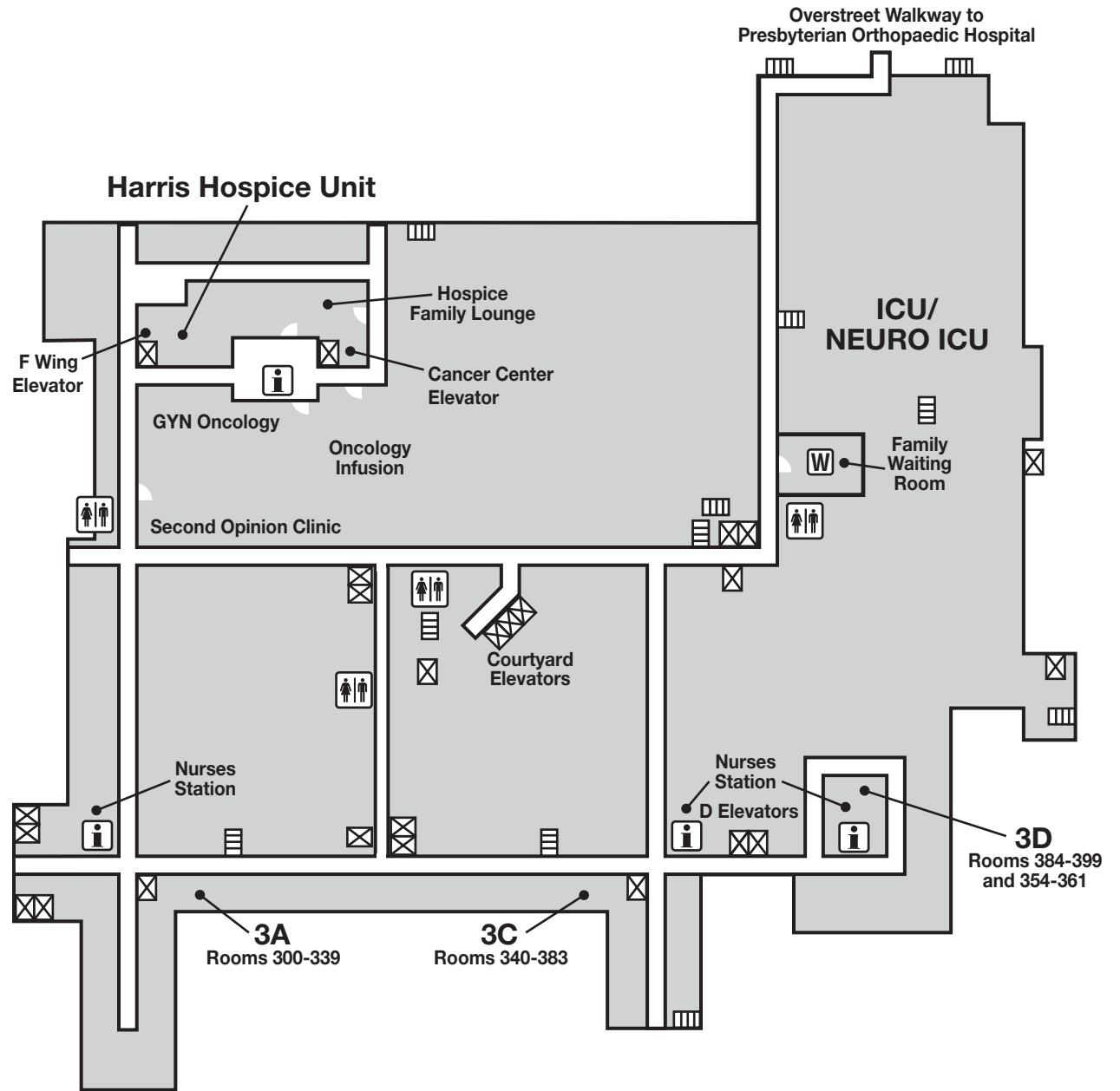

Legend			
Stairways	Elevators	Information	Waiting Area
Restrooms	Food Services	Telephones	ATM



Fourth floor

Presbyterian Medical Center

NovantHealth.org

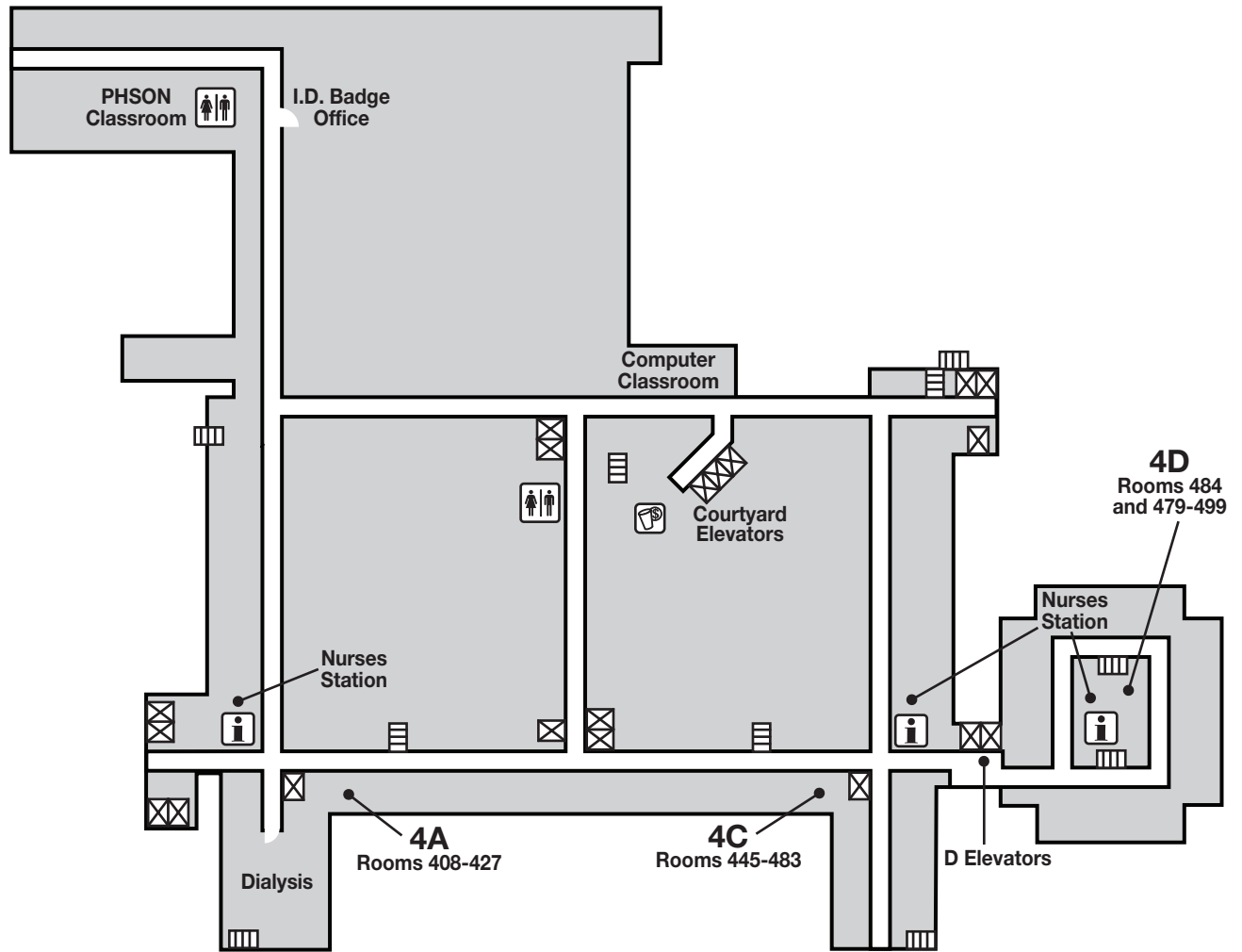

Legend			
Stairways	Elevators	Information	Waiting Area
Restrooms	Food Services	Telephones	ATM



Fifth floor

Presbyterian Medical Center

NovantHealth.org

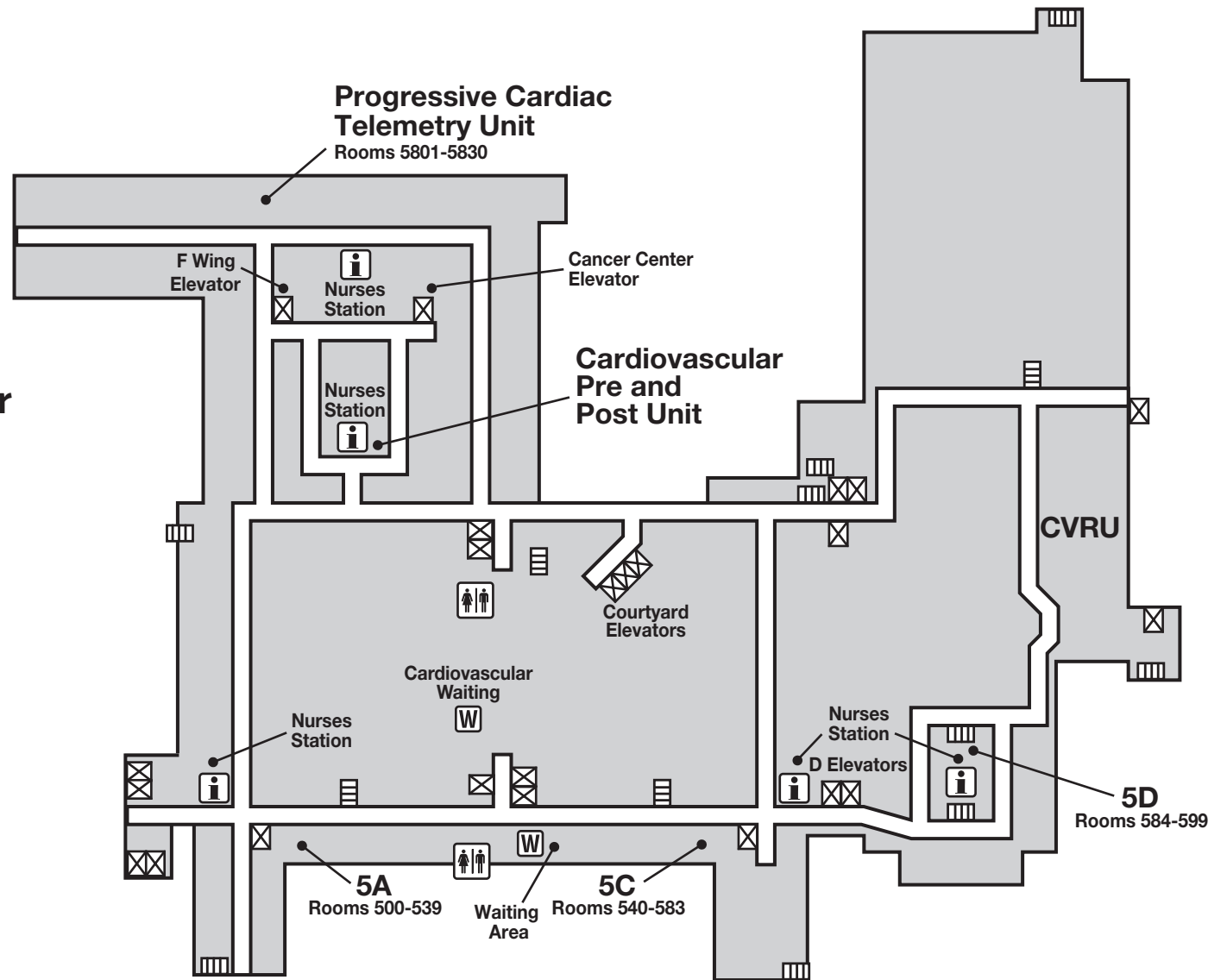

Legend			
Stairways	Elevators	Information	Waiting Area
Restrooms	Food Services	Telephones	ATM



Sixth floor

Presbyterian Medical Center

NovantHealth.org

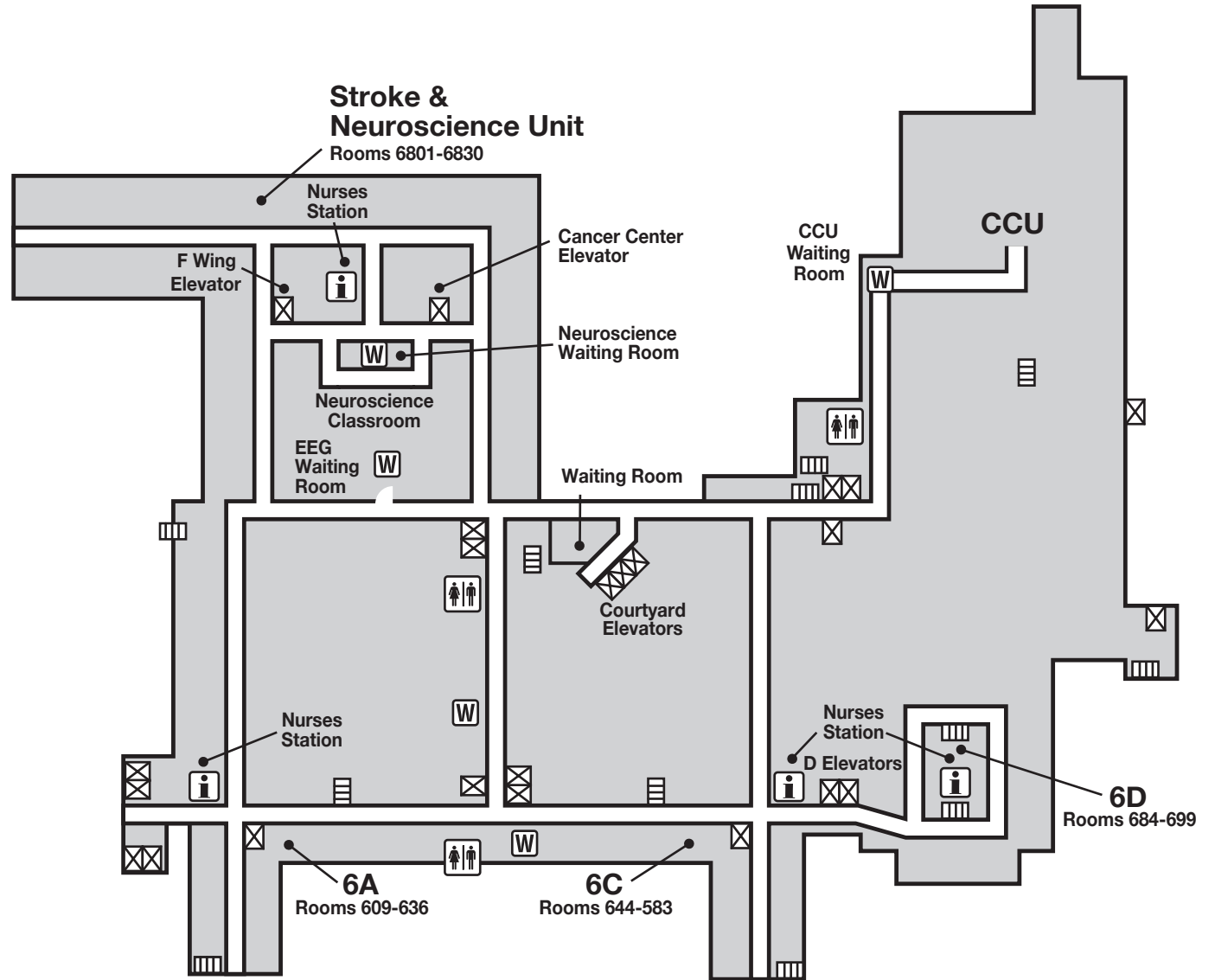

Legend			
Stairways	Elevators	Information	Waiting Area
Restrooms	Food Services	Telephones	ATM



Seventh floor

Presbyterian Medical Center

NovantHealth.org

